











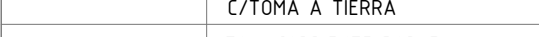
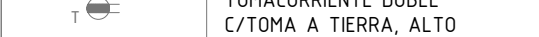

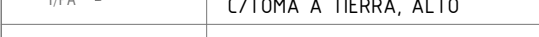
LEYENDA	
CIRCUITOS	
	CIRCUITO TEOCHO
	CIRCUITO DE PISO
SEÑALIZACIÓN	
	TOMACORRIENTE DOBLE C/TOMA A TIERRA
	TOMACORRIENTE DOBLE C/TOMA A TIERRA, ALTO
	TOMACORRIENTE DOBLE C/TOMA A TIERRA, BAJO
	S ₁ INTERRUPTOR SIMPLE
	25 _A INTERRUPTOR SIMPLE
	35 _A INTERRUPTOR SIMPLE
	53 _A INTERRUPTOR SIMPLE
	253 _A INTERRUPTOR SIMPLE
	353 _A INTERRUPTOR SIMPLE
TIPO DE LUMINARIA	
	MERCURIO HALOGENADO
	FLOURESCENTE COMPACTO
	FLOURESCENTE LINEAL
	FAROLA EMPOTRADA A PISO
	POSTE DE LUMINARIA SIMPLE
	POSTE DE LUMINARIA DOBLE
	BRAQUETE
	LUZ DE EMERGENCIA
TABLEROS	
	TABLERO GENERAL
	TABLERO DE TRANSFERENCIA AUTOMÁTICA
	TABLERO DE EMERGENCIA
	GRUPO ELECTROGENO
	TABLERO DE DISTRIBUCIÓN
	SUBTABLERO DE DISTRIBUCIÓN
	CAJA DE PASO

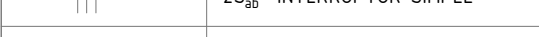
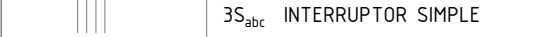
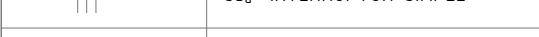
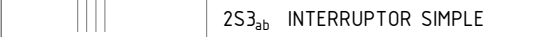
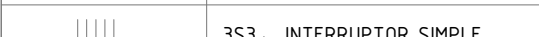
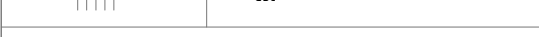
PROYECTO:

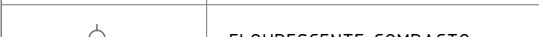
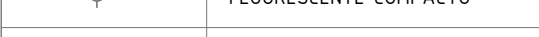
VIVIENDAS PRODUCTIVAS
Y PROCESADORA DE TRUCHA
HUARÁZ

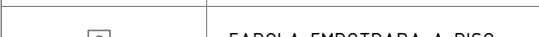
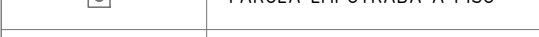
ALUMNA:

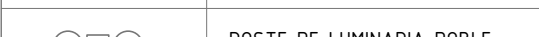
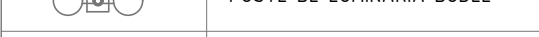
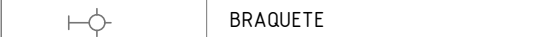
VELÁSQUEZ LÓPEZ MARGARITA T.

TOMACORRIENTES
VIVIENDA TIPO B

ESCALA:	FECHA:
1/50	ABRIL, 2021

PROFESIONAL RESPONSABLE:

ARQ. JORGE COSMÓPOLIS BULLÓN
ING. TOMAS CARRASCO ORELLANO
ING. LUIS ALBERTO RAMOS MARTINEZ
ING. JOSE CARLOS YAFAC RISCO

LAMINA:

IE-08

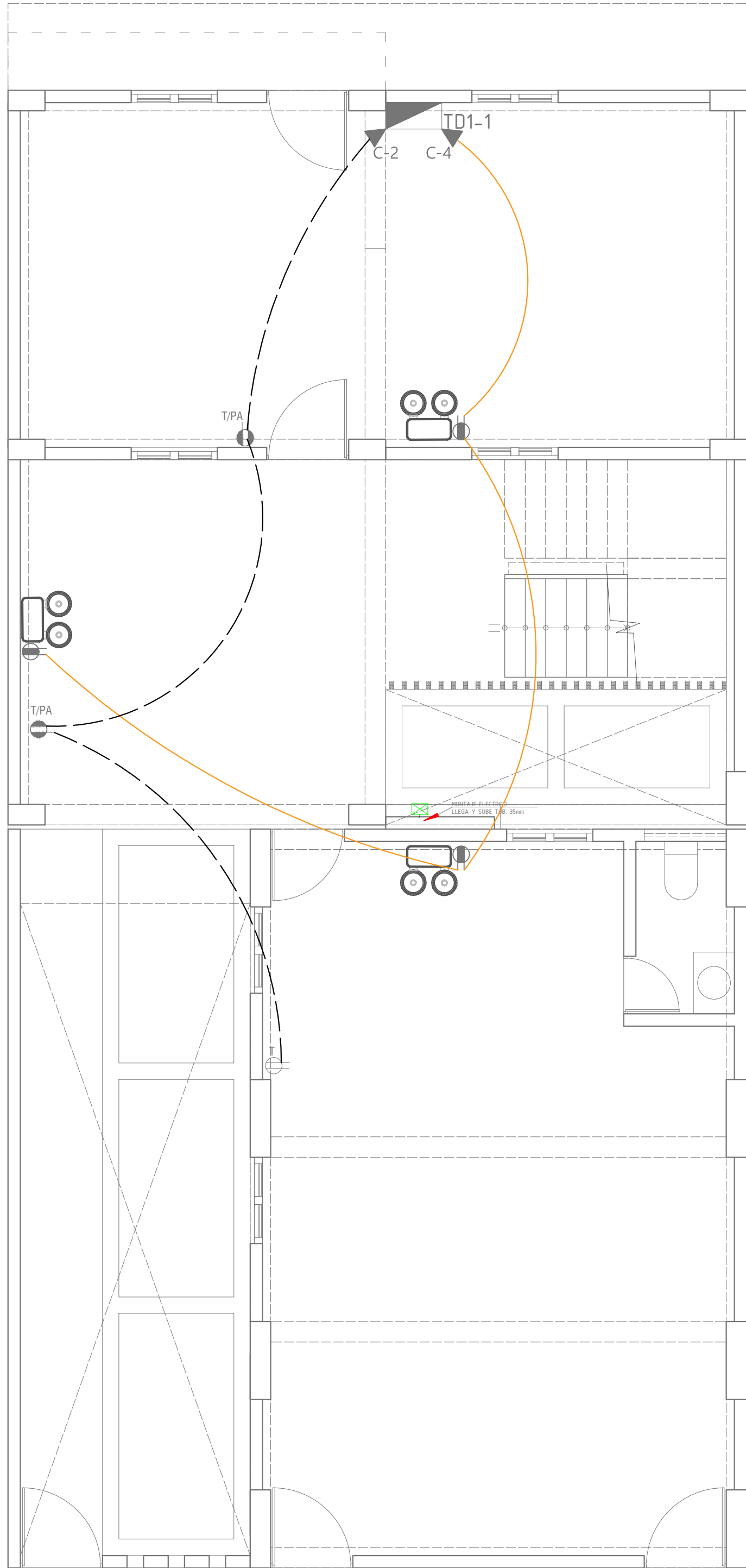

PRIMER NIVEL - TOMACORRIENTES

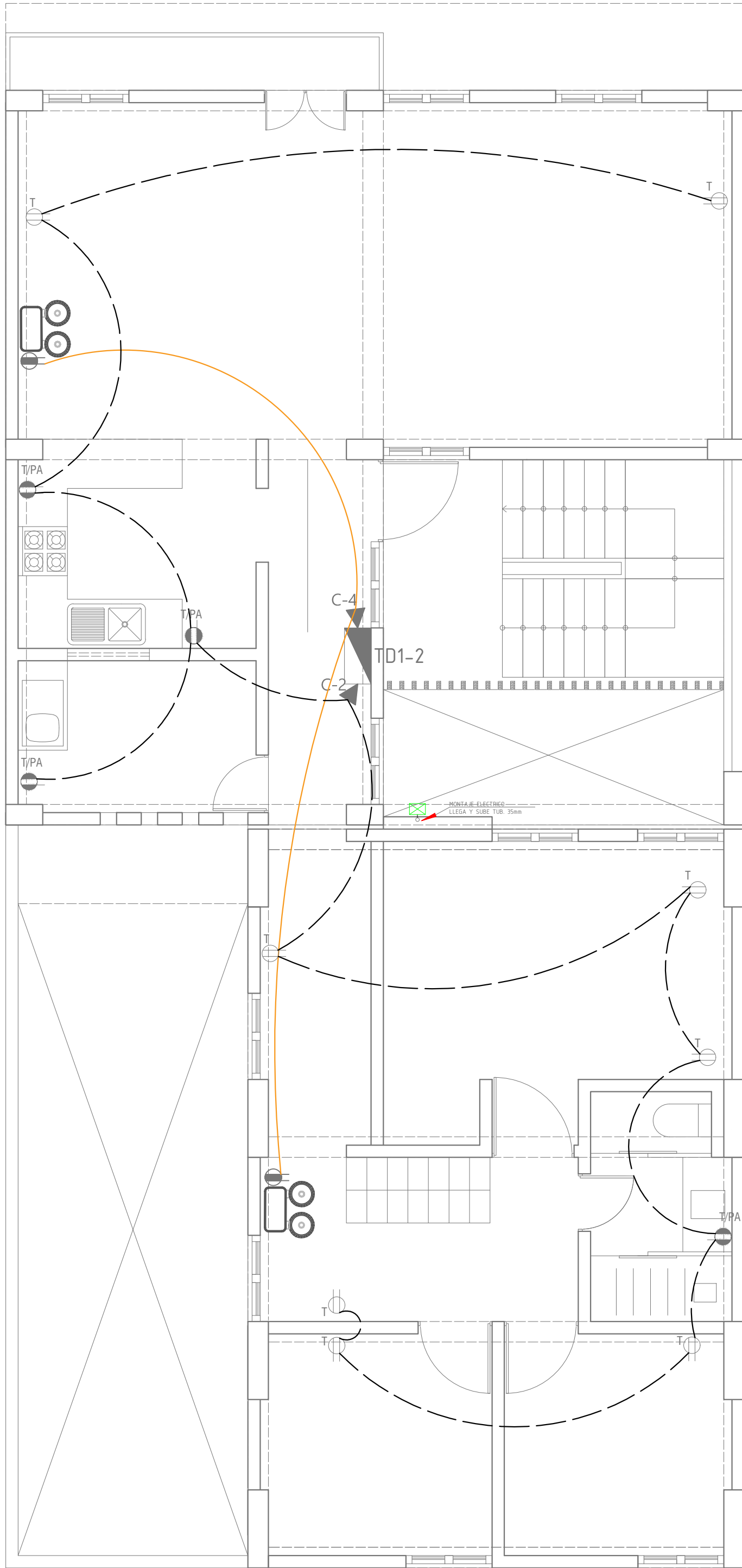

SEGUNDO NIVEL - TOMACORRIENTES

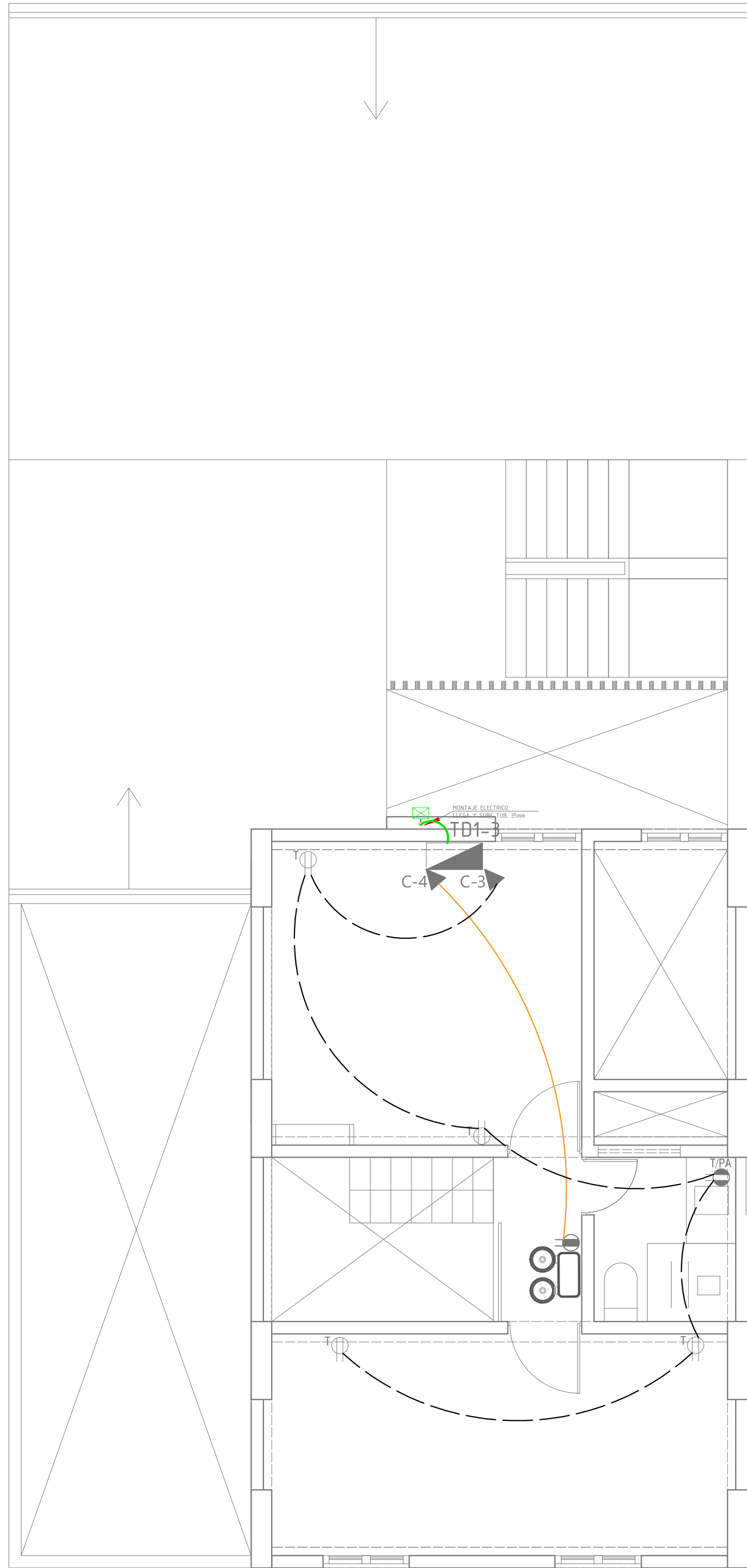

TERCER NIVEL - TOMACORRIENTES